

FOUNTAIN VALLEY POLICE DEPARTMENT

CRIME TRENDS AND ANALYSIS

FEBRUARY 2013

Fountain Valley Reporting Districts (RD)

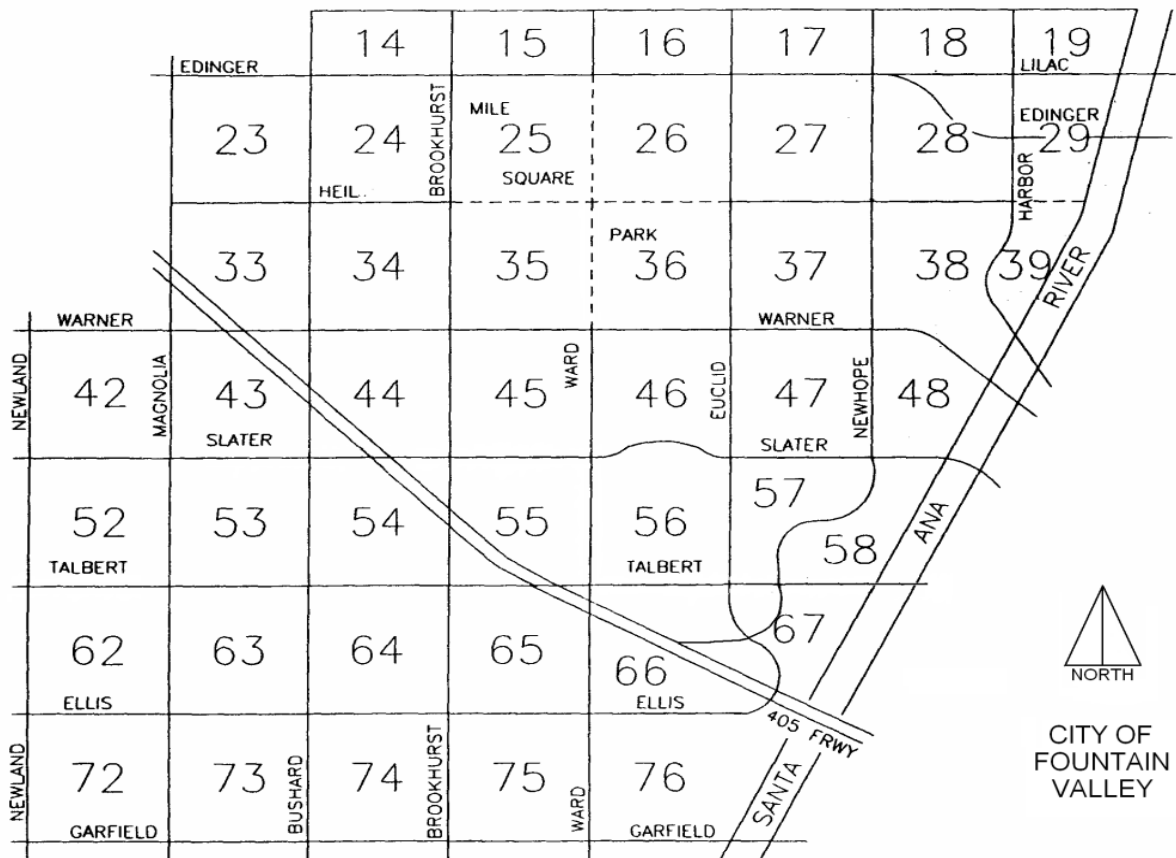



TIP OF THE MONTH: CYBERBULLYING

Cyberbullying is bullying that takes place using electronic technology. Electronic technology includes devices and equipment such as cell phones, computers, and tablets as well as communication tools including social media sites, text messages, chat, and websites.

Examples of cyberbullying include mean text messages or emails, rumors sent by email or posted on social networking sites, and embarrassing pictures, videos, websites, or fake profiles.

Reporting Cyberbullying

- Don't respond to and don't forward cyberbullying messages.
- Keep evidence of cyberbullying. Record the dates, times, and descriptions of instances when cyberbullying has occurred. Save and print screenshots, emails, and text messages. Use this evidence to report cyberbullying to web and cell phone service providers.
- Block the person who is cyberbullying.

Reporting Cyberbullying to Online Service Providers

Cyberbullying often violates the terms of service established by social media sites and internet service providers.

- Review their terms and conditions or rights and responsibilities sections. These describe content that is or is not appropriate.
- Visit social media safety centers to learn how to block users and change settings to control who can contact you.
- Report cyberbullying to the social media site so they can take action against users abusing the terms of service.

Reporting Cyberbullying to Law Enforcement

When cyberbullying involves these activities it is considered a crime and should be reported to law enforcement:

- Threats of violence
- Child pornography or sending sexually explicit messages or photos
- Taking a photo or video of someone in a place where he or she would expect privacy
- Stalking and hate crimes

Reporting Cyberbullying to Schools

- Cyberbullying can create a disruptive environment at school and is often related to in-person bullying. The school can use the information to help inform prevention and response strategies.
- In many states, schools are required to address cyberbullying in their anti-bullying policy. Some state laws also cover off-campus behavior that creates a hostile school environment.

COMMERCIAL BURGLARY

- RD 29 16000 block of Harbor on 02/04/13 @ 0459 hrs.
- RD 42 8700 block of Warner on 02/13/13 @ 0335 hrs.
- RD 42 8700 block of Warner on 02/23/13 @ 0117 hrs. Suspect was described as M/H, 20-30 y/o, 5'10"-6'01", 150-180 lbs, medium build.
- RD 74 18600 block of Brookhurst on 02/27/13 @ 0347 hrs. Suspects were described as: SU1 - M/W, 5'9", SU2 - M/W 5'7", 160 lbs, and balding, and SU3 - M/W, 5'7" 160 lbs.

RESIDENTIAL BURGLARY

- RD 16 15800 block of Los Reyes on 02/28/13 between 0930 and 1500 hrs.
- RD 23 16000 block of Cache on 02/07/13 @ 1400 hrs. Two suspects were taken into custody.
- RD 33 16900 block of Plumas between 02/03/13 and 02/04/13 @ unknown times.
- RD 43 17200 block of Walnut on 02/01/13 @ 1000 hrs. Attempt only. Suspect was described as M/H, 25 y/o, 509/165, thin build, dark hair, seen leaving in a faded black, 2dr Ford.
- RD 43 9000 block of La Colonia on 02/12/13 @ 2009 hrs. Suspects were described as 2 M/H, 20s, 506-508/140 and were seen getting into a white, Nissan 4DR sedan with tinted windows.
- RD 45 10400 block of Circulo De Villa on 02/04/13 @ 0830 hrs.
- RD 46 10700 block of El Gorra on 02/23/13 @ unknown time. Attempt only. (3 residences)
- RD 46 10700 block of El Gorra on 02/23/13 @ 0321 hrs. Attempt only. Suspects were described as 3 males 20-30 y/o, seen fleeing in a 2DR, silver/gray Nissan Sentra type vehicle.
- RD 46 10600 block of El Picador on 02/23/13 between 0300 and 0558 hrs.
- RD 53 17800 block of Ash between 02/23/13 @ 2300 and 02/24/13 @ 0400 hrs. Attempt only.
- RD 53 17800 block of Ash between 02/23/13 @ 2300 and 02/24/13 @ 0430 hrs.
- RD 56 17500 block of Vacas on 02/26/13 between 0845 and 1400 hrs.
- RD 63 9000 block of Carson River on 02/27/13 between 1000 and 2129 hrs.
- RD 65 18100 block of Mesa Verde on 02/05/13 between 1230 and 1830 hrs. Possible suspect identified.

VEHICLE BURGLARY

- RD 19 Lilac/Harbor between 02/09/13 @ 1900 and 02/10/13 @ 0400 hrs.
- RD 19 Lilac/Harbor between 02/09/13 @ 2100 and 02/10/13 @ 0400 hrs.
- RD 19 Lilac/Harbor on 02/10/13 between 0030 and 0415 hrs.
- RD 19 Lilac/Harbor between 02/10/13 @ 1500 and 02/11/13 @ 0500 hrs.
- RD 25 16400 block of Brookhurst on 02/17/13 @ 1500 hrs. Attempt only. Suspect was described as a M/H, 50 y/o, 5'10/165, medium build, dark hair with gray at the temples.
- RD 25 16400 block of Brookhurst on 02/23/13 between 1500 and 1624 hrs.
- RD 29 Harbor/Edinger on 02/11/13 @ 0904 hrs.
- RD 33 9000 block of Warner between 02/01/13 @ 1530 and 02/01/13 @ 1600 hrs.
- RD 33 9000 block of Warner on 02/12/13 between 1615 and 1730 hrs.
- RD 33 16600 block of Daisy on 02/18/13 @ 0450 hrs. Suspect was described as wearing dark clothing, getting into a early model import, possibly a Acura Integra, white in color with loud exhaust.
- RD 35 10400 block of Warner on 02/15/13 between 1300 and 1430 hrs.
- RD 37 11300 block of Warner between 02/26/13 @ 2100 and 02/27/13 @ 0600 hrs.
- RD 43 Bushard/La Luna on 02/17/13 between 0130 and 0750 hrs.
- RD 43 17300 block of Pepper Tree on 02/18/13 between 0200 and 0730 hrs. Possible suspect was described as a M/H, shaved head, driving a newer white, chevy Tahoe with tinted windows and chrome rims.
- RD 45 10400 block of Slater between 02/11/13 @ 2330 and 02/12/13 @ 0800 hrs.
- RD 46 Slater/Ward between 02/09/13 @ 2200 and 02/10/13 @ 1030 hrs.
- RD 48 17200 block of Newhope on 02/07/13 between 1720 and 1915 hrs.
- RD 55 10100 block of Talbert on 02/22/13 between 1800 and 1900 hrs.
- RD 62 18100 block of Santa Arabella on 02/23/13 @ 0500 hrs. Attempt only. Suspect was described as a M/A, 20-30 y/o, 6'0", 240 lbs, heavy build, dark hair, was seen fleeing in a 2000s, white Acura 4DR, spoiler and halogen blue lights.
- RD 64 9900 block of Talbert on 02/08/13 between 0630 and 1510 hrs.
- RD 72 18800 block of Santa Mariana between 02/06/13 @ 1800 and 02/07/13 @ 0730 hrs.
- RD 75 18700 block of Brookhurst between 02/06/13 @ 1700 and 02/07/13 @ 0900 hrs.

STOLEN VEHICLE

- RD 23 16300 block of Myrtlewood between 02/16/13 @ 2300 and 02/17/13 @ 0700 hrs. The vehicle was located by Long Beach PD with no one in custody.
- RD 25 Brookhurst/Heil on 02/05/13 between 1700 and 1800 hrs. The vehicle was located by Fountain Valley PD in Santa Ana with no one in custody.
- RD 29 12000 block of Sylvan River between 02/03/13 @ 2100 and 02/04/13 @ 1741 hrs. The vehicle was located by Santa Ana PD with no one in custody.
- RD 43 17400 block of Oak on 02/03/13 @ 0930 hrs. The vehicle was located by Long Beach PD with no one in custody.
- RD 53 17800 block of Ash between 02/23/13 @ 2300 and 02/24/13 @ 0430 hrs. The vehicle was located by Huntington Beach PD with no one in custody. Related to the residential burglary.
- RD 64 9800 block of Swan on 02/03/13 @ 1450 hrs. 1999 Yamaha YZF600R M/C, green in color. Vehicle has not been located. Suspect descriptions are SU1 – M/B, 34 y/o, 603/185, thin build, is in the military, SU2 – M/B, 21 y/o, 506/200, heavy build, SU3 – M/B, 30 y/o, 600/205 heavy build, SU4 – M/W, 27 y/o, 505/135, heavy build, red hair, and suspect vehicle is a 2000 black 4dr with Mag wheels.

RECOVERED VEHICLES STOLEN FROM OTHER CITIES

- RD 44 17400 block of Brookhurst on 02/19/13 @ 1237 hrs. The vehicle was originally taken from Huntington Beach. Two suspects were taken into custody.
- RD 66 18400 block of Bandilier on 02/22/13 @ 1407 hrs. The vehicle was originally taken from Anaheim. No one in custody.

GRAFFITI

FROM 02-01-13 TO 02-07-13

<u>RD</u>	<u>#</u>	<u>LOCATION</u>	<u>CREW OR TAGGING</u>
27	2	16200 Mt Bodie	TOK
28	1	San Jacinto/Azalea	SAS
29	1	Harbor/Heil	SAW
29	1	Heil/Harbor	SAS
29	2	Harbor/Heil	CANTA RAYAS

FROM 02-08-13 TO 02-14-13

<u>RD</u>	<u>#</u>	<u>LOCATION</u>	<u>CREW OR TAGGING</u>
19		Harbor/Lilac	No Photos
28		San Jacinto/Violet	
28		San Jacinto/Violet	
28		Edinger/Mt Ackerman	

28 16400 Everest
 28 16400 Everest
 29 Edinger/Mt Gustin

FROM 02-15-13 TO 02-28-13

<u>RD</u>	<u>#</u>	<u>LOCATION</u>	<u>CREW OR TAGGING</u>
18	1	Lilac/Sterling	Illegible
19	2	Harbor/Lilac	CSB
28	2	Heil/Everest	BISC
28	2	Edinger/Mt Gustin	BISC
28	1	Foothill/Heil	BIS
28	4	Everest/Heil	SW Tas Dem
28	1	Heil/Everest	SAS
28	1	Heil/Foothill	BIS
28	2	San Jacinto/Violet	SENO RAC
28	3	Everest/Heil	RTB "FAMILIA MAFIOSO"
28		Edinger/Iris	No Photo
29	2	Edinger/Mt Gustin	Taze SW Chugg
29	4	Edinger/Mt Gustin	DMK
29	1	Edinger/Mt Gustin	BISC
29	1	Edinger/Mt Gustin	BISC
37	3	Warner/Mt Hope	RTBC
38	4	Harbor/Goodale	RTBK IM WNER RTB
53	1	Talbert/Bay	Biers
55	1	17900 Los Alamos	326
55	6	17900 Los Alamos	DRV DIGZ Heil CHUE

COYOTE OBSERVATION LOG

- RD 38 Lassen/Wisteria on 02/28/13 @ 0042 hrs. Two coyotes seen in the area.
- RD 47 Euclid/Slater on 02/26/13 @ 0916 hrs. Coyote seen in the area.
- RD 62 8600 block of Rogue River on 02/03/13 @ evening time. Coyote tried to attack a dog.
- RD 63 18400 block of Gifford on 02/05/13 @ 0817 hrs. Injured coyote seen in the area.
- RD 73 18700 block of Cordata on 02/06/13 @ 1958 hrs. Coyote seen in the area.

- 5 - Total coyote related incidents
- 5 - Actual coyote sightings
- 1 - Sightings with multiple coyotes
- 1 - Sightings with coyote(s) preying on a cat or dog

** All calls were relayed to Orange County Animal Control.



FOUNTAIN VALLEY POLICE DEPT IS NOW ON FACEBOOK!!!
Click [here](#) to visit our page and read about the latest cases, get questions answered and post comments.

WE WANT TO KNOW!!

Do you have any questions for us? If you have a general question about our policies, procedures, general information, tips, etc., please email it to us at: crimewatch@fountainvalley.org.

THE FOUNTAIN VALLEY POLICE DEPARTMENT